

# PACKING SLIP

Manufactured by:  
**M/s. JAYPEE ENTERPRISES**  
 10, Mungekar Indl. Estate, Off. Aarey Road,  
 Goregoan (East) Mumbai - 400 063. (India)  
 Email : [jpe2005@rediffmail.com](mailto:jpe2005@rediffmail.com)  
[www.jaypeeflushsystem.com](http://www.jaypeeflushsystem.com)

- (1) Identification Number
- (2) Derlin Valve : Diaphragm Type
- (3) Material of cistern & cover : PP
- (4) Discharge capacity : 10 Litres

1. TANK AND LID
2. OVERFLOW WITH WASHER
3. FLUSHING HANDLE
4. STUD
5. CONNECTION ARM
6. TOP NUT
7. PULL ROD
8. DERLIN VALVE
9. WASHER LEVEL ADJUSTING SCREW
10. FLOAT ARM
11. FLOAT
12. WATER LEVEL ADJUSTING SCREW
13. BETA VALVE
14. RUBER WASHER-JF-20
15. SEAT WASHER-JF-18
16. CHECK NUT
17. OUTLET BEND PIPE
18. O RING
19. PLASTIC CUP
20. RUBBER BELOW
21. WALL BRACKETS (2 NOS.)

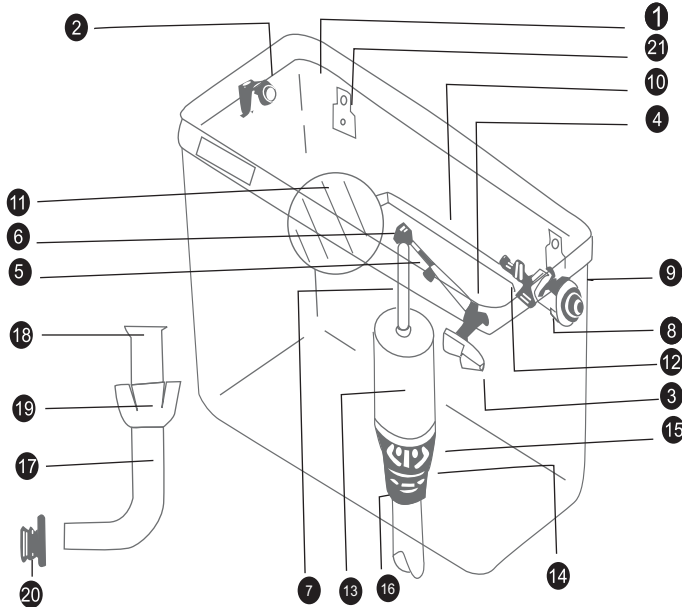

## COMPLAINT

- (a) Leakage through outlet pipe
- (b) Leakage through other joints

## REMEDY

Check if any particle is there between seat and rubber washer tighten bottom checkout otherwise replace rubberV-washer or O-ring

# Warranty cum Installation Guide

## FLUSHING CISTERN

An ISO 9001 : 2015 Certified Company

### ( Warranty Terms )

- 1) Each and every Ready To Fit Cistern is tested on working waterline and is free from defective material or workmanship and functioning for a period of One year from the date of sale.
- 2) The product will not be replaced.
- 3) This warranty will not hold in an event of abuse, misuse, mishandling & improper installation, modification or repairs by unauthorised people.
- 4) In case of muddy hard water or boring water if scaling is the their, the company shall not be responsible for improper functioning and warranty shall be void.
- 5) Please ensure a proper installation of tank by good plumber, we shall not be responsible for faulty installation
- 6) Please contact us at following address.



**M/s. JAYPEE ENTERPRISES**  
 10, Mungekar Indl. Estate, Off. Aarey Road,  
 Goregoan (East) Mumbai - 400 063. (India)  
 Email : [jpe2005@rediffmail.com](mailto:jpe2005@rediffmail.com)  
[www.jaypeeflushsystem.com](http://www.jaypeeflushsystem.com)  
 Customer Care No. (022) 2927 1048

We thank you for buying Ready to Fit Cistern today You'll thank us for it in the years to come!!